

1.Specifications & Dimension

1.1 Parts No.:

ARR-BP600L-CA8

1.2 Specifications:

- DC Breakdown Voltage: $600V \pm 15\%$ (@rising voltage 100V/s)
- Surge Breakdown Voltage: $\leq 1200V$ (@rising voltage 1000V/ μ s)
- Life Tests:
 - AC Discharge Current: 20A (5 times, 1s per time with 3mins interval)
 - Surge Discharge Current:
 - 200A (10/1000 μ s, 300times with 3mins interval)
 - 20KA (8/20 μ s, 10times with 3mins interval)
- Insulation Resistance: $\geq 10000M\Omega$
- Electrode Capacitance: ≤ 1.5 pF (@1MHz)

1.3 Dimension: (unit:mm)

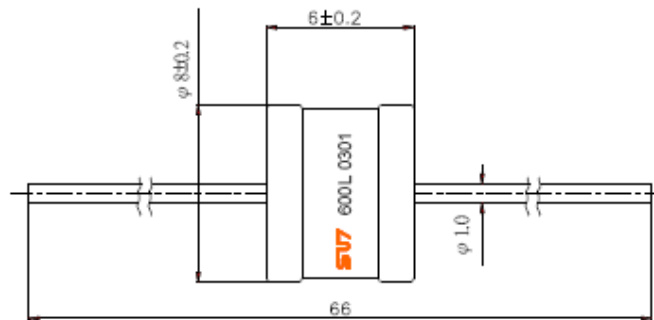

1.1 Parts No.:

ARR-BP470L-CA8

1.2 Specifications:

- DC Breakdown Voltage: $470V \pm 15\%$ (@rising voltage 100V/s)
- Surge Breakdown Voltage: $\leq 1000V$ (@rising voltage 1000V/ μ s)
- Life Tests:
 - AC Discharge Current: 20A (5 times, 1s per time with 3mins interval)
 - Surge Discharge Current:
 - 200A (10/1000 μ s, 300times with 3mins interval)
 - 20KA (8/20 μ s, 10times with 3mins interval)
- Insulation Resistance: $\geq 10000M\Omega$
- Electrode Capacitance: ≤ 1.5 pF (@1MHz)

1.3 Dimension: (unit:mm)

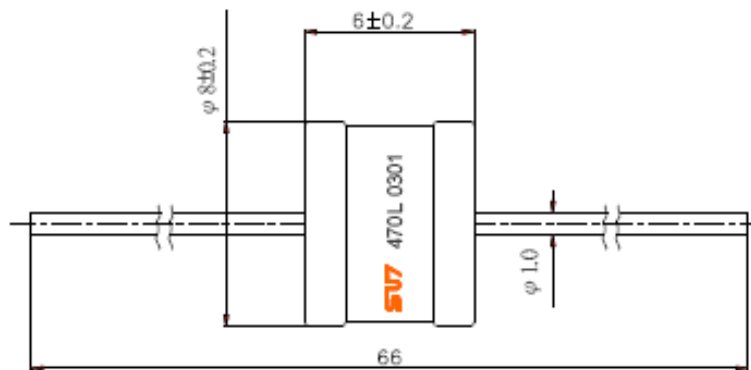

1.1 Parts No.:

ARR-BP350L-CA8

1.2 Specifications:

- DC Breakdown Voltage: $350V \pm 15\%$ (@rising voltage 100V/s)
- Surge Breakdown Voltage: $\leq 900V$ (@rising voltage 1000V/ μ s)
- Life Tests:
 - AC Discharge Current: 20A (5 times, 1s per time with 3mins interval)
 - Surge Discharge Current:
 - 200A (10/1000 μ s, 300times with 3mins interval)
 - 20KA (8/20 μ s, 10times with 3mins interval)
- Insulation Resistance: $\geq 10000M\Omega$
- Electrode Capacitance: ≤ 1.5 pF (@1MHz)

1.3 Dimension: (unit:mm)

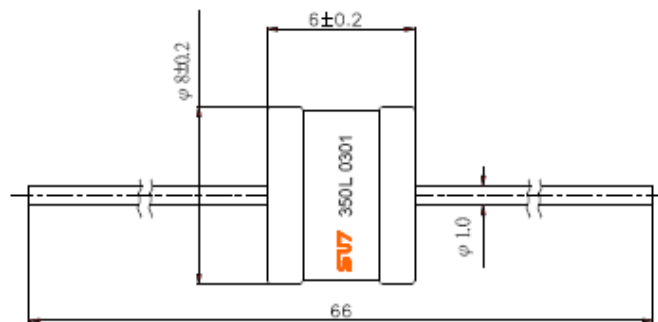

1.1 Parts No.:

ARR-BP230L-CA8

1.2 Specifications:

- DC Breakdown Voltage: $230V \pm 15\%$ (@rising voltage $100V/s$)
- Surge Breakdown Voltage: $\leq 700V$ (@rising voltage $1000V/\mu s$)
- Life Tests:
 - AC Discharge Current: 20A (5 times, 1s per time with 3mins interval)
 - Surge Discharge Current:
 - 200A (10/1000 μs , 300times with 3mins interval)
 - 20KA (8/20 μs , 10times with 3mins interval)
- Insulation Resistance: $\geq 10000M\Omega$
- Electrode Capacitance: $\leq 1.5 pF$ (@1MHz)

1.3 Dimension: (unit:mm)

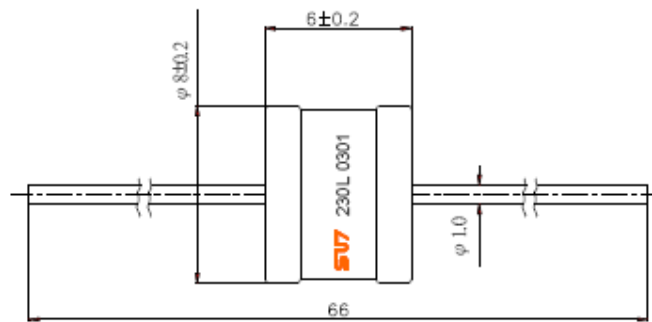

1.1 Parts No.:

ARR-BP150L-CA8

1.2 Specifications:

- DC Breakdown Voltage: $150V \pm 15\%$ (@rising voltage 100V/s)
- Surge Breakdown Voltage: $\leq 650V$ (@rising voltage 1000V/ μ s)
- Life Tests:
 - AC Discharge Current: 20A (5 times, 1s per time with 3mins interval)
 - Surge Discharge Current:
 - 200A (10/1000 μ s, 300times with 3mins interval)
 - 20KA (8/20 μ s, 10times with 3mins interval)
- Insulation Resistance: $\geq 10000M\Omega$
- Electrode Capacitance: ≤ 1.5 pF (@1MHz)

1.3 Dimension: (unit:mm)

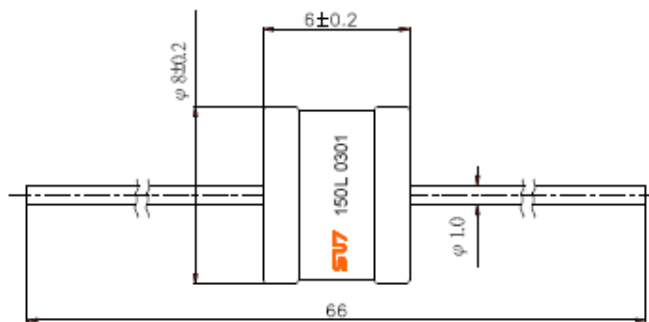

1.1 Parts No.:

ARR-BP090L-CA8

1.2 Specifications:

- DC Breakdown Voltage: $90V \pm 15\%$ (@rising voltage 100V/s)
- Surge Breakdown Voltage: $\leq 650V$ (@rising voltage 1000V/ μ s)
- Life Tests:
 - AC Discharge Current: 20A (5 times, 1s per time with 3mins interval)
 - Surge Discharge Current:
 - 200A (10/1000 μ s,300times with 3mins interval)
 - 20KA (8/20 μ s,10times with 3mins interval)
- Insulation Resistance: $\geq 10000M\Omega$
- Electrode Capacitance: ≤ 1.5 pF (@1MHz)

1.3 Dimension: (unit:mm)

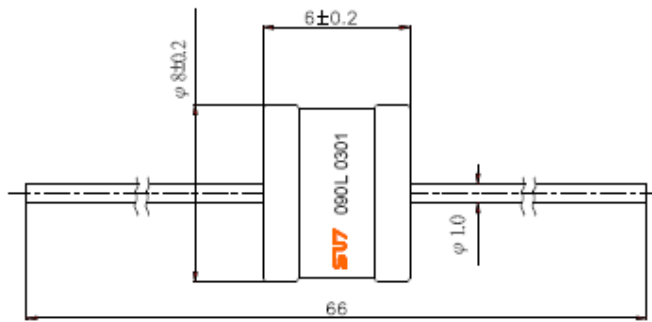

1.1 Parts No.:

ARR-BP075L-CA8

1.2 Specifications:

- DC Breakdown Voltage: $75V \pm 15\%$ (@rising voltage 100V/s)
- Surge Breakdown Voltage: $\leq 650V$ (@rising voltage 1000V/ μ s)
- Life Tests:
 - AC Discharge Current: 20A (5 times, 1s per time with 3mins interval)
 - Surge Discharge Current:
 - 200A (10/1000 μ s,300times with 3mins interval)
 - 20KA (8/20 μ s,10times with 3mins interval)
- Insulation Resistance: $\geq 10000M\Omega$
- Electrode Capacitance: ≤ 1.5 pF (@1MHz)

1.3 Dimension: (unit:mm)

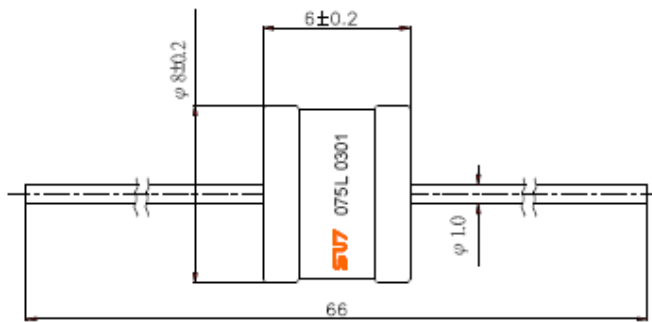

1.1 Parts No.:

ARR-AP600L-CA8

1.2 Specifications:

- DC Breakdown Voltage: $600V \pm 15%$ (@rising voltage 100V/s)
- Surge Breakdown Voltage: $\leq 1200V$ (@rising voltage 1000V/ μs)
- Life Tests:
 - AC Discharge Current: 20A (5 times, 1s per time with 3mins interval)
 - Surge Discharge Current:
 - 200A (10/1000 μs , 300times with 3mins interval)
 - 20kA (8/20 μs , 10times with 3mins interval)
- Insulation Resistance: $\geq 10000M\Omega$
- Electrode Capacitance: $\leq 1.5 pF$ (@1MHz)

1.3 Dimension: (unit:mm)

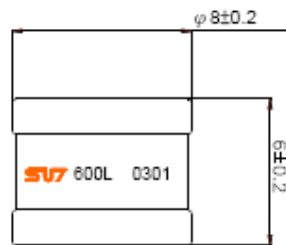

1.1 Parts No.:

ARR-AP470L-CAS

1.2 Specifications:

- DC Breakdown Voltage: $470V \pm 15%$ (@rising voltage 100V/s)
- Surge Breakdown Voltage: $\leq 1000V$ (@rising voltage 1000V/ μ s)
- Life Tests:
 - AC Discharge Current: 20A (5 times, 1s per time with 3mins interval)
 - Surge Discharge Current:
 - 200A (10/1000 μ s, 300times with 3mins interval)
 - 20kA (8/20 μ s, 10times with 3mins interval)
- Insulation Resistance: $\geq 10000M\Omega$
- Electrode Capacitance: ≤ 1.5 pF (@1MHz)

1.3 Dimension: (unit:mm)

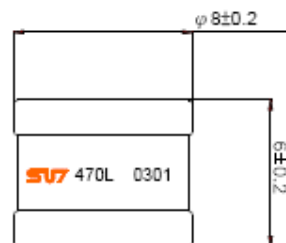

1.1 Parts No.:

ARR-AP350L-CA8

1.2 Specifications:

- DC Breakdown Voltage: $350V \pm 15\%$ (@rising voltage 100V/s)
- Surge Breakdown Voltage: $\leq 900V$ (@rising voltage 1000V/ μ s)
- Life Tests:
 - AC Discharge Current: 20A (5 times, 1s per time with 3mins interval)
 - Surge Discharge Current:
 - 200A (10/1000 μ s, 300times with 3mins interval)
 - 20kA (8/20 μ s, 10times with 3mins interval)
- Insulation Resistance: $\geq 10000M\Omega$
- Electrode Capacitance: ≤ 1.5 pF (@1MHz)

1.3 Dimension: (unit:mm)

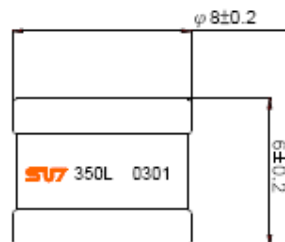

1.1 Parts No.:

ARR-AP230L-CA8

1.2 Specifications:

- DC Breakdown Voltage: $230V \pm 15\%$ (@rising voltage 100V/s)
- Surge Breakdown Voltage: $\leq 700V$ (@rising voltage 1000V/ μ s)
- Life Tests:
 - AC Discharge Current: 20A (5 times, 1s per time with 3mins interval)
 - Surge Discharge Current:
200A (10/1000 μ s, 300times with 3mins interval)
20kA (8/20 μ s, 10times with 3mins interval)
- Insulation Resistance: $\geq 10000M\Omega$
- Electrode Capacitance: ≤ 1.5 pF (@1MHz)

1.3 Dimension: (unit:mm)

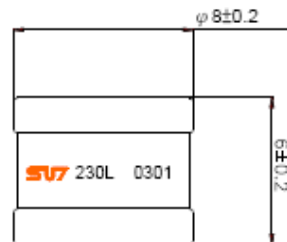

1.1 Parts No.:

ARR-API50L-CA8

1.2 Specifications:

- DC Breakdown Voltage: $150V \pm 15\%$ (@rising voltage 100V/s)
- Surge Breakdown Voltage: $\leq 650V$ (@rising voltage 1000V/ μ s)
- Life Tests:
 - AC Discharge Current: 20A (5 times, 1s per time with 3mins interval)
 - Surge Discharge Current:
 - 200A (10/1000 μ s,300times with 3mins interval)
 - 20kA (8/20 μ s,10times with 3mins interval)
- Insulation Resistance: $\geq 10000M\Omega$
- Electrode Capacitance: ≤ 1.5 pF (@1MHz)

1.3 Dimension: (unit:mm)

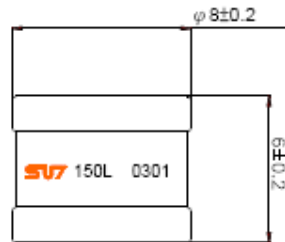

1.1 Parts No.:

ARR-AP090L-CA8

1.2 Specifications:

- DC Breakdown Voltage: $90V \pm 15\%$ (@rising voltage 100V/s)
- Surge Breakdown Voltage: $\leq 650V$ (@rising voltage 1000V/ μ s)
- Life Tests:
 - AC Discharge Current: 20A (5 times, 1s per time with 3mins interval)
 - Surge Discharge Current:
 - 200A (10/1000 μ s,300times with 3mins interval)
 - 20kA (8/20 μ s,10times with 3mins interval)
- Insulation Resistance: $\geq 10000M\Omega$
- Electrode Capacitance: ≤ 1.5 pF (@1MHz)

1.3 Dimension: (unit:mm)

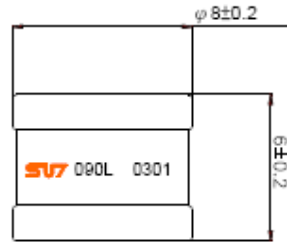

1.1 Parts No.:

ARR-AP075L-CA8

1.2 Specifications:

- DC Breakdown Voltage: $75V \pm 15\%$ (@rising voltage 100V/s)
- Surge Breakdown Voltage: $\leq 650V$ (@rising voltage 1000V/ μ s)
- Life Tests:
 - AC Discharge Current: 20A (5 times, 1s per time with 3mins interval)
 - Surge Discharge Current:
 - 200A (10/1000 μ s, 300times with 3mins interval)
 - 20kA (8/20 μ s, 10times with 3mins interval)
- Insulation Resistance: $\geq 10000M\Omega$
- Electrode Capacitance: ≤ 1.5 pF (@1MHz)

1.3 Dimension: (unit:mm)

