

# 1.Specifications & Dimension

## 1.1 Parts No.:

**ARR-AM075L-CA8**

## 1.2 Specifications:

- DC Breakdown Voltage:  $75V \pm 15\%$  (@rising voltage 100V/s)
- Surge Breakdown Voltage:  $\leq 650V$  (@rising voltage 1000V/ $\mu s$ )
- Life Tests:
  - AC Discharge Current: 10A (5 times, 1s per time with 3mins interval)
  - Surge Discharge Current:  
100A (10/1000 $\mu s$ , 300times with 3mins interval)  
10kA (8/20 $\mu s$ , 10times with 3mins interval)
- Insulation Resistance:  $\geq 10000M\Omega$
- Electrode Capacitance:  $\leq 1.5 pF$  (@1MHz)

## 1.3 Dimension: (unit:mm)

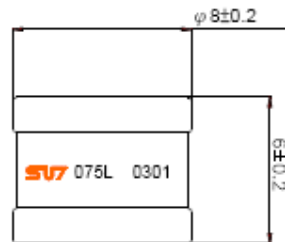

1.1 Parts No.:

**ARR-AM090L-CA8**

1.2 Specifications:

- DC Breakdown Voltage:  $90V \pm 15\%$  (@rising voltage 100V/s)
- Surge Breakdown Voltage:  $\leq 700V$  (@rising voltage 1000V/ $\mu$ s)
- Life Tests:
  - AC Discharge Current: 10A (5 times, 1s per time with 3mins interval)
  - Surge Discharge Current:
    - 100A (10/1000 $\mu$ s, 300times with 3mins interval)
    - 10kA (8/20 $\mu$ s, 10times with 3mins interval)
- Insulation Resistance:  $\geq 10000M\Omega$
- Electrode Capacitance:  $\leq 1.5$  pF (@1MHz)

1.3 Dimension: (unit:mm)

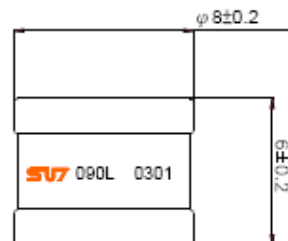

1.1 Parts No.:

**ARR-AM150L-CA8**

1.2 Specifications:

- DC Breakdown Voltage:  $150V \pm 15\%$  (@rising voltage 100V/s)
- Surge Breakdown Voltage:  $\leq 700V$  (@rising voltage 1000V/ $\mu$ s)
- Life Tests:
  - AC Discharge Current: 10A (5 times, 1s per time with 3mins interval)
  - Surge Discharge Current:
    - 100A (10/1000 $\mu$ s, 300times with 3mins interval)
    - 10kA (8/20 $\mu$ s, 10times with 3mins interval)
- Insulation Resistance:  $\geq 10000M\Omega$
- Electrode Capacitance:  $\leq 1.5$  pF (@1MHz)

1.3 Dimension: (unit:mm)

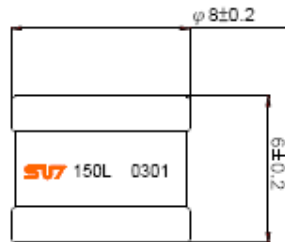

1.1 Parts No.:

**ARR-AM230L-CA8**

1.2 Specifications:

- DC Breakdown Voltage:  $230V \pm 15\%$  (@rising voltage 100V/s)
- Surge Breakdown Voltage:  $\leq 700V$  (@rising voltage 1000V/ $\mu$ s)
- Life Tests:
  - AC Discharge Current: 10A (5 times, 1s per time with 3mins interval)
  - Surge Discharge Current:
    - 100A (10/1000 $\mu$ s, 300times with 3mins interval)
    - 10kA (8/20 $\mu$ s, 10times with 3mins interval)
- Insulation Resistance:  $\geq 10000M\Omega$
- Electrode Capacitance:  $\leq 1.5$  pF (@1MHz)

1.3 Dimension: (unit:mm)

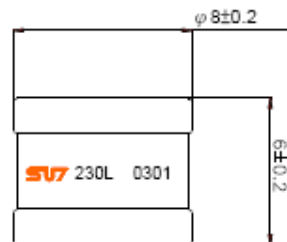

1.1 Parts No.:

**ARR-AM350L-CA8**

1.2 Specifications:

- DC Breakdown Voltage:  $350V \pm 15\%$  (@rising voltage 100V/s)
- Surge Breakdown Voltage:  $\leq 900V$  (@rising voltage 1000V/ $\mu$ s)
- Life Tests:
  - AC Discharge Current: 10A (5 times, 1s per time with 3mins interval)
  - Surge Discharge Current:
    - 100A (10/1000 $\mu$ s, 300times with 3mins interval)
    - 10kA (8/20 $\mu$ s, 10times with 3mins interval)
- Insulation Resistance:  $\geq 10000M\Omega$
- Electrode Capacitance:  $\leq 1.5$  pF (@1MHz)

1.3 Dimension: (unit:mm)

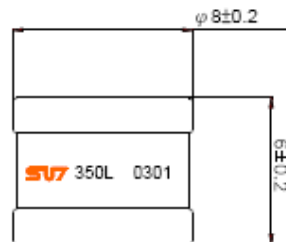

1.1 Parts No.:

**ARR-AM470L-CA8**

1.2 Specifications:

- DC Breakdown Voltage:  $470V \pm 15\%$  (@rising voltage 100V/s)
- Surge Breakdown Voltage:  $\leq 1000V$  (@rising voltage 1000V/ $\mu$ s)
- Life Tests:
  - AC Discharge Current: 10A (5 times, 1s per time with 3mins interval)
  - Surge Discharge Current:
    - 100A (10/1000 $\mu$ s, 300times with 3mins interval)
    - 10kA (8/20 $\mu$ s, 10times with 3mins interval)
- Insulation Resistance:  $\geq 10000M\Omega$
- Electrode Capacitance:  $\leq 1.5$  pF (@1MHz)

1.3 Dimension: (unit:mm)

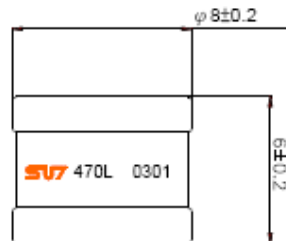

1.1 Parts No.:

**ARR-AM600L-CA8**

1.2 Specifications:

- DC Breakdown Voltage:  $600V \pm 15\%$  (@rising voltage 100V/s)
- Surge Breakdown Voltage:  $\leq 1200V$  (@rising voltage 1000V/ $\mu s$ )
- Life Tests:
  - AC Discharge Current: 10A (5 times, 1s per time with 3mins interval)
  - Surge Discharge Current:
    - 100A (10/1000 $\mu s$ , 300times with 3mins interval)
    - 10kA (8/20 $\mu s$ , 10times with 3mins interval)
- Insulation Resistance:  $\geq 10000M\Omega$
- Electrode Capacitance:  $\leq 1.5 pF$  (@1MHz)

1.3 Dimension: (unit:mm)

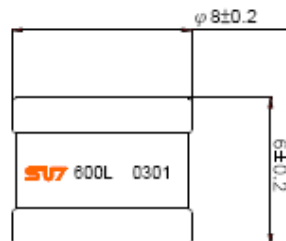

1.1 Parts No.:

**ARR-BM075L-CA8**

1.2 Specifications:

- DC Breakdown Voltage:  $75V \pm 15\%$  (@rising voltage 100V/s)
- Surge Breakdown Voltage:  $\leq 650V$  (@rising voltage 1000V/ $\mu$ s)
- Life Tests:
  - AC Discharge Current: 10A (5 times, 1s per time with 3mins interval)
  - Surge Discharge Current:
    - 100A (10/1000 $\mu$ s,300times with 3mins interval)
    - 10KA (8/20 $\mu$ s,10times with 3mins interval)
- Insulation Resistance:  $\geq 10000M\Omega$
- Electrode Capacitance:  $\leq 1.5$  pF (@1MHz)

1.3 Dimension: (unit:mm)

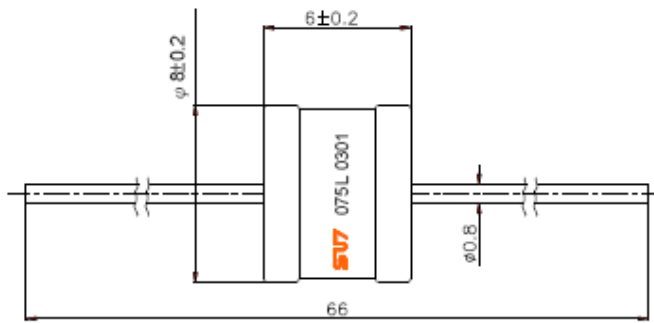

1.1 Parts No.:

**ARR-BM090L-CA8**

1.2 Specifications:

- DC Breakdown Voltage:  $90V \pm 15\%$  (@rising voltage 100V/s)
- Surge Breakdown Voltage:  $\leq 700V$  (@rising voltage 1000V/ $\mu$ s)
- Life Tests:
  - AC Discharge Current: 10A (5 times, 1s per time with 3mins interval)
  - Surge Discharge Current:
    - 100A (10/1000 $\mu$ s, 300times with 3mins interval)
    - 10KA (8/20 $\mu$ s, 10times with 3mins interval)
- Insulation Resistance:  $\geq 10000M\Omega$
- Electrode Capacitance:  $\leq 1.5$  pF (@1MHz)

1.3 Dimension: (unit:mm)

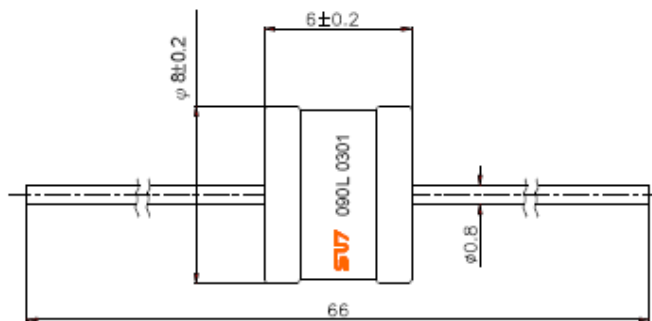

### 1.1 Parts No.:

**ARR-BM150L-CA8**

### 1.2 Specifications:

- DC Breakdown Voltage:  $150V \pm 15\%$  (@rising voltage 100V/s)
- Surge Breakdown Voltage:  $\leq 700V$  (@rising voltage 1000V/ $\mu$ s)
- Life Tests:
  - AC Discharge Current: 10A (5 times, 1s per time with 3mins interval)
  - Surge Discharge Current:
    - 100A (10/1000 $\mu$ s, 300times with 3mins interval)
    - 10KA (8/20 $\mu$ s, 10times with 3mins interval)
- Insulation Resistance:  $\geq 10000M\Omega$
- Electrode Capacitance:  $\leq 1.5$  pF (@1MHz)

### 1.3 Dimension: (unit:mm)

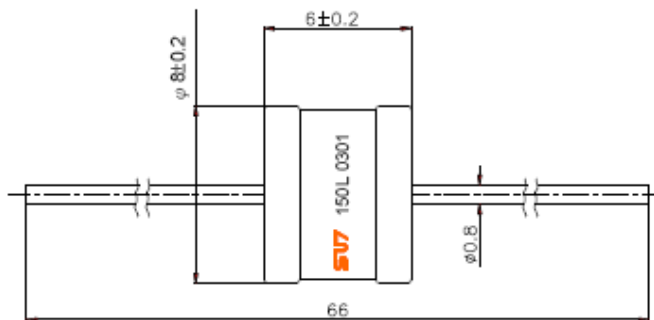

1.1 Parts No.:

**ARR-BM230L-CA8**

1.2 Specifications:

- DC Breakdown Voltage:  $230V \pm 15\%$  (@rising voltage 100V/s)
- Surge Breakdown Voltage:  $\leq 700V$  (@rising voltage 1000V/ $\mu$ s)
- Life Tests:
  - AC Discharge Current: 10A (5 times, 1s per time with 3mins interval)
  - Surge Discharge Current:
    - 100A (10/1000 $\mu$ s,300times with 3mins interval)
    - 10KA (8/20 $\mu$ s,10times with 3mins interval)
- Insulation Resistance:  $\geq 10000M\Omega$
- Electrode Capacitance:  $\leq 1.5$  pF (@1MHz)

1.3 Dimension: (unit:mm)

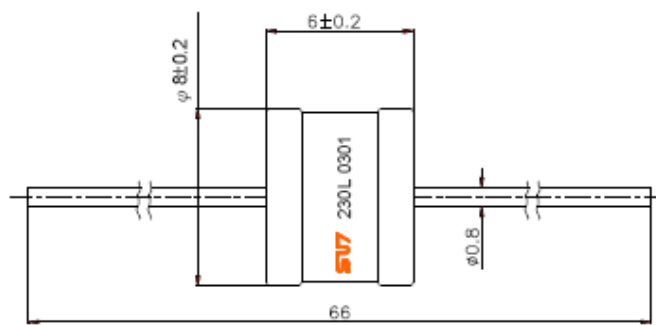

1.1 Parts No.:

**ARR-BM350L-CA8**

1.2 Specifications:

- DC Breakdown Voltage:  $350V \pm 15%$  (@rising voltage 100V/s)
- Surge Breakdown Voltage:  $\leq 900V$  (@rising voltage 1000V/ $\mu$ s)
- Life Tests:
  - AC Discharge Current: 10A (5 times, 1s per time with 3mins interval)
  - Surge Discharge Current:
    - 100A (10/1000 $\mu$ s, 300times with 3mins interval)
    - 10KA (8/20 $\mu$ s, 10times with 3mins interval)
- Insulation Resistance:  $\geq 10000M\Omega$
- Electrode Capacitance:  $\leq 1.5$  pF (@1MHz)

1.3 Dimension: (unit:mm)

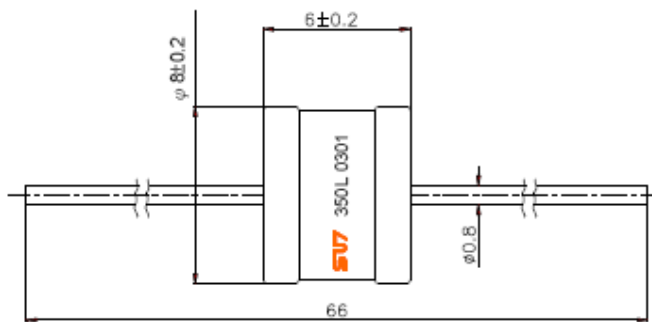

1.1 Parts No.:

**ARR-BM470L-CA8**

1.2 Specifications:

- DC Breakdown Voltage:  $470V \pm 15\%$  (@rising voltage 100V/s)
- Surge Breakdown Voltage:  $\leq 1000V$  (@rising voltage 1000V/ $\mu$ s)
- Life Tests:
  - AC Discharge Current: 10A (5 times, 1s per time with 3mins interval)
  - Surge Discharge Current:
    - 100A (10/1000 $\mu$ s, 300times with 3mins interval)
    - 10KA (8/20 $\mu$ s, 10times with 3mins interval)
- Insulation Resistance:  $\geq 10000M\Omega$
- Electrode Capacitance:  $\leq 1.5$  pF (@1MHz)

1.3 Dimension: (unit:mm)

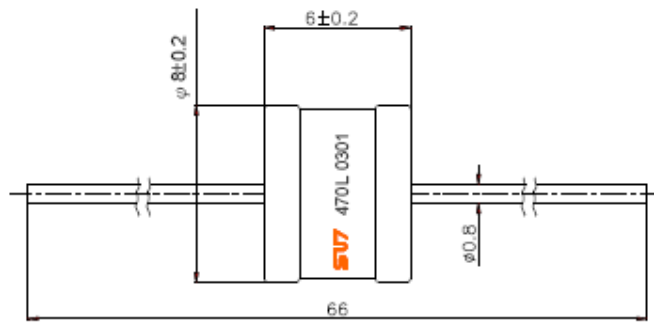

1.1 Parts No.:

**ARR-BM600L-CA8**

1.2 Specifications:

- DC Breakdown Voltage:  $600V \pm 15\%$  (@rising voltage 100V/s)
- Surge Breakdown Voltage:  $\leq 1200V$  (@rising voltage 1000V/ $\mu s$ )
- Life Tests:
  - AC Discharge Current: 10A (5 times, 1s per time with 3mins interval)
  - Surge Discharge Current:
    - 100A (10/1000 $\mu s$ , 300times with 3mins interval)
    - 10KA (8/20 $\mu s$ , 10times with 3mins interval)
- Insulation Resistance:  $\geq 10000M\Omega$
- Electrode Capacitance:  $\leq 1.5 pF$  (@1MHz)

1.3 Dimension: (unit:mm)

