

SMD PUSH WIRE CONNECTOR FOR LED APPLICATIONS

Discrete Wire-to-Board;

Series SM C09 0045

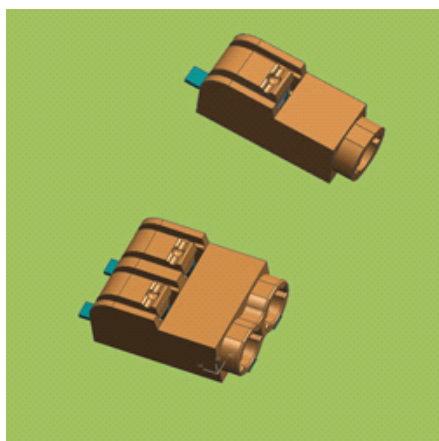

- Schmid-M introduces the SMD connector of new SM C09 0045 series into market. Generally, it is clamp push button connector suitable for hard as well as stranded wires. With height only 5.0mm it is very suitable for LED lighting equipment and installation inside electronic devices with limited available space.
- Connector shape is very tight which makes it ideal choice for PCB surface-mount applications. Using s-type cage spring connection technology allows single hard wire to be accommodated easily and quickly. Push button connector is convenient for multi storied wire connections. Connector uses reliable and modern design with vertically inserted wire and horizontally positioned push
- In addition, tiny shape and low profile of the shell minimizes the shadow effect.
- Reel packing is suitable for automatic assembly. It can accommodate wires with the cross-section in between 0.2–0.75mm² (AWG 24–18), rated current is 6 A, operating voltage is 320V

APPLICATIONS

1. Connecting discrete wire components directly to the PCB
2. Bringing power and signals onto a PCB
3. Daisy chaining PCB's together to create a continuous string of boards

FEATURES AND BENEFITS

1. Simple strip, insert and removal design
2. SMT RoHS termination to the PCB with minimal footprint
3. Accepts 24–18AWG Solid and Stranded wires
4. Expanded size offering to maximize application potential; 1&2 positions
5. Available in standard white color

ELECTRICAL

- Current Rating: 6 Amps / Contact
- Voltage Rating: 320 VAC
- Wire Size: 24–18AWG
0.2–0.75 mm²
- Strip Length: 6–7MM/0.24~0.28 inch

ENVIRONMENTAL

- Operating Temperature:
–40°C to +125°C

MECHANICAL

- Insulator Material: Nylon46 UL94V2 flame retardant
- Contact Material: Phosphor Bronze
- Plating: Tin

1 WAY WIRE TO BOARD CONNECTOR

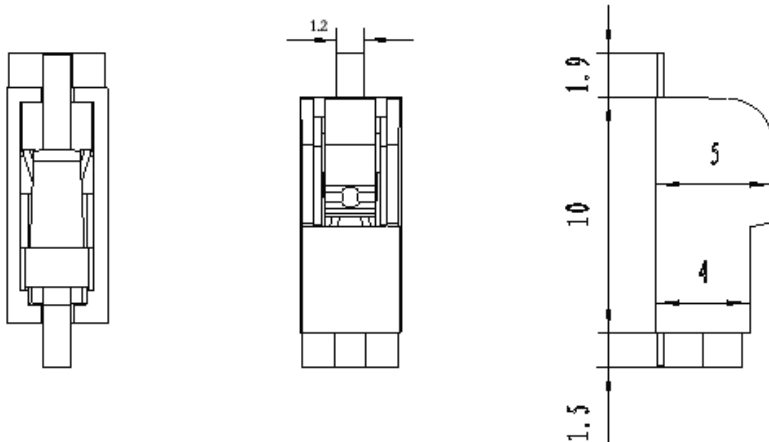
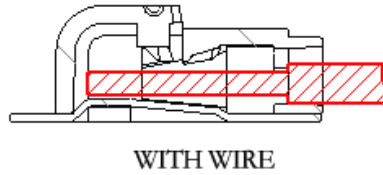
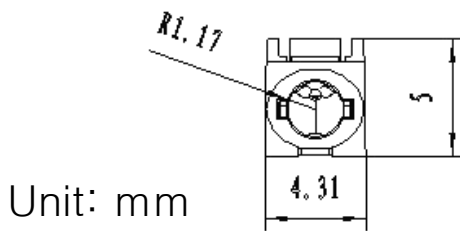

PACKING DETAILS

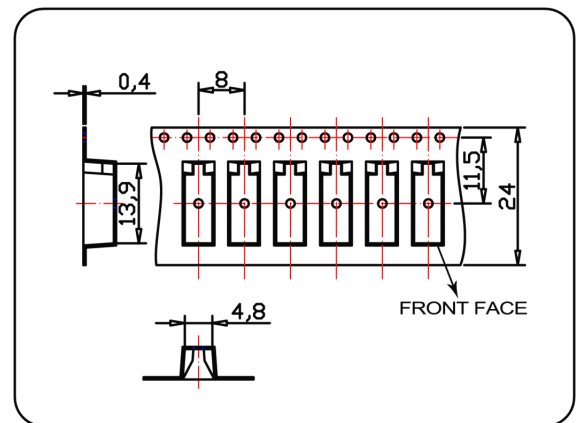

1 WAY PCB BOARD LAYOUT

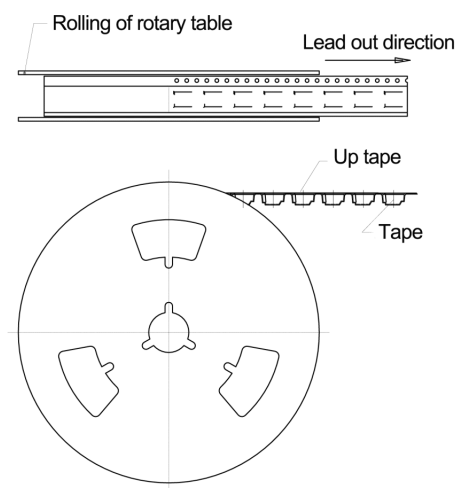
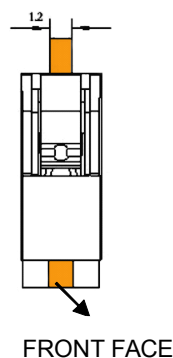
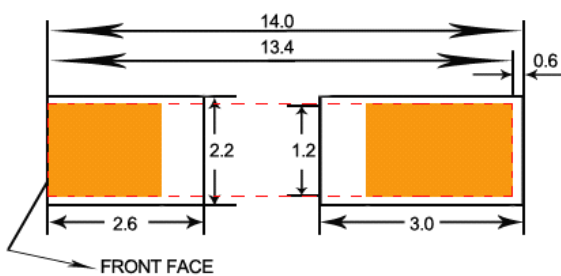

NOTES:

1. ITEM NO.: SM C09 0045 01 SMD
2. INSULATOR MATERIAL: Nylon46 UL94V2 FLAME-RETARDANT
3. CONTACT MATERIAL: COPPER ALLOY, 0.30MM THICK, TIN PLATED.
4. FRONT FACE OF CONNECTOR CAN BE IN LINE WITH EDGE OF PCB.
5. PACKING TAPE AND REEL, QUANTITY 1500 PCS PER REEL.
6. COLOR: WHITE OR AS PER CUSTOMER REQUIREMENT

2 WAY WIRE TO BOARD CONNECTOR

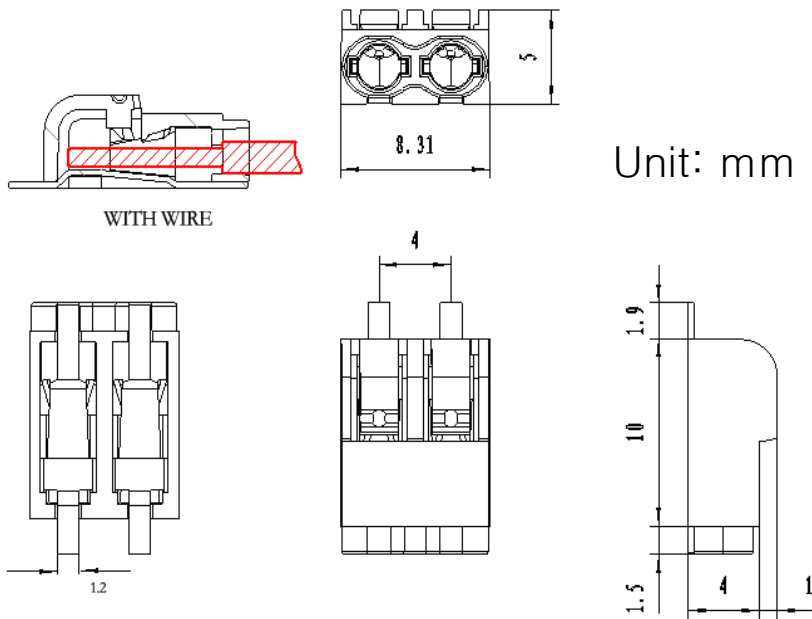

2 WAY PCB BOARD LAYOUT

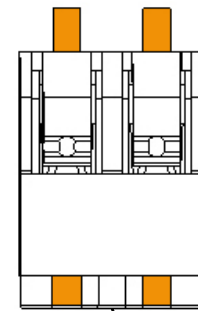
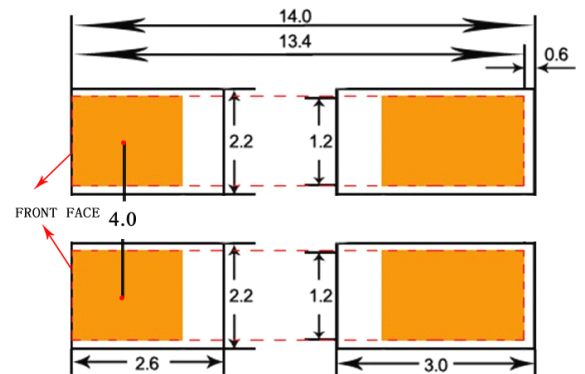

PACKING DETAILS

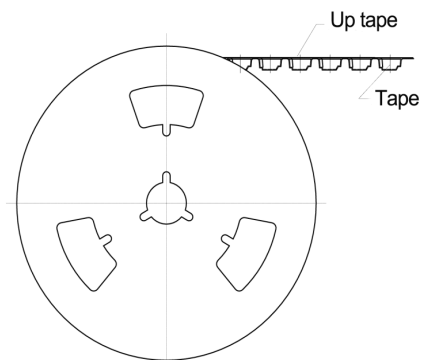
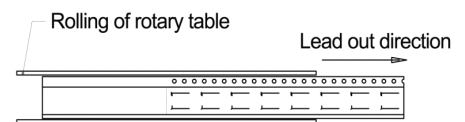
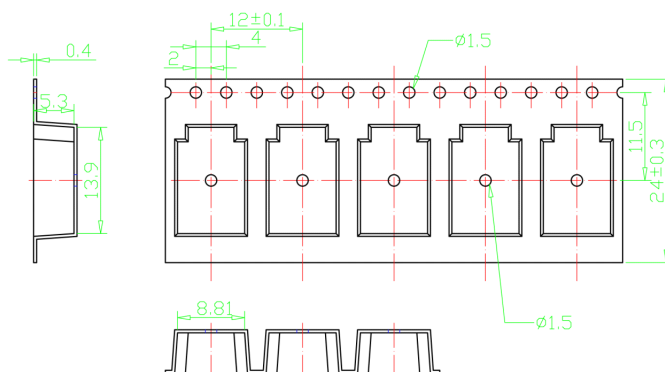

NOTES:

1. ITEM NO.: SM C09 0045 02 SMD
2. INSULATOR MATERIAL: Nylon46 UL94V2 FLAME-RETARDANT
3. CONTACT MATERIAL: COPPER ALLOY, 0.30MM THICK, TIN PLATED.
4. FRONT FACE OF CONNECTOR CAN BE IN LINE WITH EDGE OF PCB.
5. PACKING TAPE AND REEL, QUANTITY 1000 PCS PER REEL.
6. COLOR: WHITE OR AS PER CUSTOMER REQUIREMENT